

CODE 4013

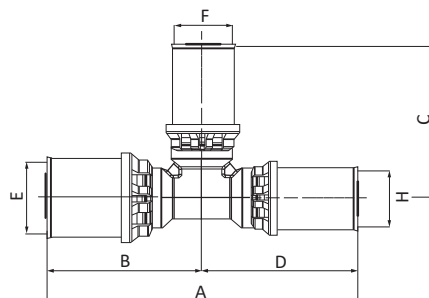

Ti a 90° ridotto - 90° Reducing tee - Té à 90° réduit - Te 90° reducida - T-Stück 90° reduziert - Тройник 90° редукционный



CODE	DIM [mm]	A [mm]	B [mm]	C [mm]	D [mm]	E [mm]	F [mm]	H [mm]	PACK			€/pz
									BAG [UMV]	OT1	OT2	
4013181618001	18x16x18	86	43	39	43	18x2,0	16x2,0	18x2,0	2	16	-	13,83
4013201616001	20x16x16	88	44	45	44	20x2,0	16x2,0	16x2,0	2	16	-	13,09
4013201620001	20x16x20	88	44	43	44	20x2,0	16x2,0	20x2,0	2	16	-	13,83
4013201820001	20x18x20	88	44	43	44	20x2,0	18x2,0	20x2,0	2	16	-	14,16
4013202016001	20x20x16	88	44	45	44	20x2,0	20x2,0	16x2,0	2	16	-	14,16
4013261620001	26x16x20	94	47	45	47	26x3,0	16x2,0	20x2,0	2	12	-	18,45
4013261626001	26x16x26	94	47	45	47	26x3,0	16x2,0	26x3,0	2	12	-	22,12
4013262020001	26x20x20	94	47	47	47	26x3,0	20x2,0	20x2,0	2	12	-	20,70
4013262026001	26x20x26	94	47	47	47	26x3,0	20x2,0	26x3,0	2	12	-	22,54
4013262616001	26x26x16	94	47	46	47	26x3,0	26x3,0	16x2,0	2	12	-	21,32
4013262620001	26x26x20	94	47	46	47	26x3,0	26x3,0	20x2,0	2	12	-	21,85
4013322032001	32x20x32	118	59	52	59	32x3,0	20x2,0	32x3,0	2	8	-	31,34
4013322626001	32x26x26	110	56	54	54	32x3,0	26x3,0	26x3,0	2	8	-	35,13
4013322632001	32x26x32	116	58	54	58	32x3,0	26x3,0	32x3,0	2	8	-	37,03
4013402640001	40x26x40	146	73	56	73	40x3,5	26x3,0	40x3,5	1	4	-	78,07
4013403232001	40x32x32	133	69	65	64	40x3,5	32x3,0	32x3,0	1	5	-	73,68
4013403240001	40x32x40	144	72	61	72	40x3,5	32x3,0	40x3,5	1	4	-	78,21
4013502650001	50x26x50	162	81	71	81	50x4,0	26x3,0	50x4,0	1	-	8	151,61
4013503250001	50x32x50	178	89	71	89	50x4,0	32x3,0	50x4,0	1	-	8	151,61
4013504050001	50x40x50	178	89	83	89	50x4,0	40x3,5	50x4,0	1	-	8	151,61
4013633263001	63x32x63	162	81	81	81	63x4,5	32x3,0	63x4,5	1	-	-	165,11
4013634063001	63x40x63	162	81	85	81	63x4,5	40x3,5	63x4,5	1	-	-	165,11
4013635063001	63x50x63	196	98	91	98	63x4,5	50x4,0	63x4,5	1	-	4	240,28

GENERAL TECHNICAL SPECIFICATIONS





DeltaPress WATER

Unidelta manufactures a wide range of MultiProfile brass press fittings (DeltaPress Water), suitable for heating systems at both low temperatures (radiant panels) and high temperatures (radiators) as well as for cooling systems, antifreeze and snowmelt systems. These fittings were designed and manufactured to be pressed with the most common clamping profiles.

Fig. 1 - Profiles of the jaws

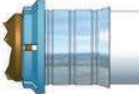

	Profile TH	Profile H	Profile U					
Jaws Profile	Ø16 [mm]	Ø18 [mm]	Ø20 [mm]	Ø26 [mm]	Ø32 [mm]	Ø40 [mm]	Ø50 [mm]	Ø63 [mm]
TH	✓	✓	✓	✓	✓	✓	✓	✓
H	✓	✓	✓	✓	✓	✓	-	-
U	✓	✓	✓	-	✓	✓	✓	✓

The range of Delta Press Water press fittings is compatible with:

- Pipes PE-RT/Al/PE-RT: **FlexAll**;
- Pipes PE-X: **UniTerm**, **TriTerm** Ø16x2,0 e Ø20x2,0;
- Pipes PE-RT: **UniPert** e **MultiPert Plus** Ø16x2,0 e Ø20x2,0.

Figure 2 shows the structure of a DeltaPress Water.

① The body of the fitting is made of a brass with excellent corrosion resistance. The rubber-holder profile has a saw-tooth geometry ensuring a greater traction hold, and is equipped with chamfers to facilitate the connection with the pipe, thus avoiding soliciting the components.

② The particular feature of the bushing ring nut in nylon is that it has inspection holes that make it possible to verify the correct insertion of the pipe up to the stop point of the barbs that do not allow contact between the metal part of the pipe and the fitting, thereby preventing the onset of galvanic corrosion.

③ The bushing is made of solubilised stainless steel for greater ductility in pressing.

④ Two O-rings, which guarantee a greater water seal, made of peroxide EPDM to be used for transporting potable water.

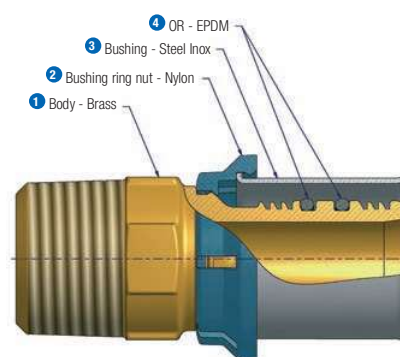

Fig. 2 - Structure of a DeltaPress Water