

CODE 4005

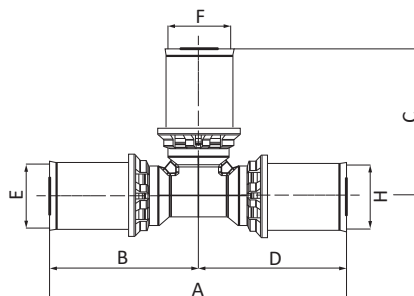

Ti a 90° - 90° Tee - Té à 90° - Te, tres bocas union tubo - T-Stück 90° - Тройник 90°



CODE	DIM [mm]	A [mm]	B [mm]	C [mm]	D [mm]	E [mm]	F [mm]	H [mm]	PACK			€/pz
									BAG [UMV]	OT1	OT2	
4005160000001	16x16x16	84	42	42	42	16x2,0	16x2,0	16x2,0	2	20	-	11,13
4005180000001	18x18x18	88	44	44	44	18x2,0	18x2,0	18x2,0	2	16	-	14,57
4005200000001	20x20x20	90	45	45	45	20x2,0	20x2,0	20x2,0	2	16	-	14,57
4005260000001	26x26x26	94	47	47	47	26x3,0	26x3,0	26x3,0	2	10	-	23,46
4005320000001	32x32x32	116	58	58	58	32x3,0	32x3,0	32x3,0	2	8	-	37,38
4005400000001	40x40x40	146	73	73	73	40x3,5	40x3,5	40x3,5	1	4	-	78,78
4005500000001	50x50x50	178	89	89	89	50x4,0	50x4,0	50x4,0	1	-	7	138,55
4005630000001	63x63x63	198	99	99	99	63x4,5	63x4,5	63x4,5	1	-	4	235,77

CODE 4029



Ti a 90° con derivazione maggiorata - 90° Tee with increased take off - Té à 90° avec dérivation augmentée

Te 90° con derivación aumentada - T-Stück 90° mit vergrößertem Mittelabgang - Тройник 90° с выходом на больший диаметр

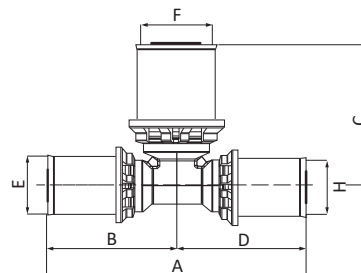

CODE	DIM [mm]	A [mm]	B [mm]	C [mm]	D [mm]	E [mm]	F [mm]	H [mm]	PACK		€/pz
									BAG [UMV]	OT1	
4029162016001	16x20x16	90	45	42	45	16x2,0	20x2,0	16x2,0	2	16	14,16
4029202620001	20x26x20	96	48	56	48	20x2,0	26x3,0	20x2,0	2	12	21,39

GENERAL TECHNICAL SPECIFICATIONS



DeltaPress WATER

Unidelta manufactures a wide range of MultiProfile brass press fittings (DeltaPress Water), suitable for heating systems at both low temperatures (radiant panels) and high temperatures (radiators) as well as for cooling systems, antifreeze and snowmelt systems. These fittings were designed and manufactured to be pressed with the most common clamping profiles.

Fig. 1 - Profiles of the jaws

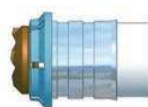

 Profile TH

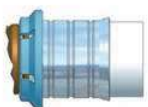
 Profile H

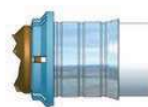
 Profile U

Jaws Profile	Ø16 [mm]	Ø18 [mm]	Ø20 [mm]	Ø26 [mm]	Ø32 [mm]	Ø40 [mm]	Ø50 [mm]	Ø63 [mm]
TH	✓	✓	✓	✓	✓	✓	✓	✓
H	✓	✓	✓	✓	✓	✓	-	-
U	✓	✓	✓	-	✓	✓	✓	✓

The range of Delta Press Water press fittings is compatible with:

- Pipes PE-RT/Al/PE-RT: **FlexAll**;
- Pipes PE-X: **UniTerm**, **TriTerm** Ø16x2,0 e Ø20x2,0;
- Pipes PE-RT: **UniPert** e **MultiPert Plus** Ø16x2,0 e Ø20x2,0.

Figure 2 shows the structure of a DeltaPress Water.

① The body of the fitting is made of a brass with excellent corrosion resistance. The rubber-holder profile has a saw-tooth geometry ensuring a greater traction hold, and is equipped with chamfers to facilitate the connection with the pipe, thus avoiding soliciting the components.

② The particular feature of the bushing ring nut in nylon is that it has inspection holes that make it possible to verify the correct insertion of the pipe up to the stop point of the barbs that do not allow contact between the metal part of the pipe and the fitting, thereby preventing the onset of galvanic corrosion.

③ The bushing is made of solubilised stainless steel for greater ductility in pressing.

④ Two O-rings, which guarantee a greater water seal, made of peroxide EPDM to be used for transporting potable water.

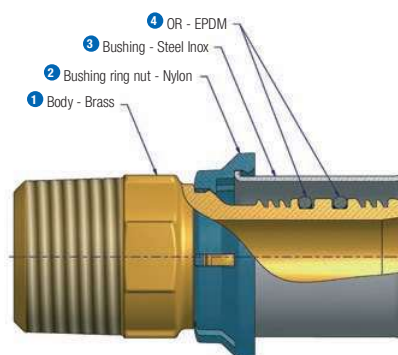

Fig. 2 - Structure of a DeltaPress Water